



1.0 PRODUCT DESCRIPTION

Available Sizes:

- 14 – 60"/DN350 – DN1500

Maximum Working Pressure:

- Pressure ratings for Victaulic AGS fittings conform to the ratings of the Style W07 or Style W77 couplings (refer to publications [20.02](#) or [20.03](#) for more information)

Function:

- Connects pipe, provides change in direction and adapts to sizes or components
- Supplied with Victaulic AGS grooves
- Exclusively for use with Victaulic couplings, valves, accessories and pipe which feature ends formed with the Victaulic AGS groove profile

2.0 CERTIFICATION/LISTINGS



ALWAYS REFER TO ANY NOTIFICATIONS AT THE END OF THIS DOCUMENT REGARDING PRODUCT INSTALLATION, MAINTENANCE OR SUPPORT.

System No.		Location	
Submitted By		Date	

Spec Section		Paragraph	
Approved		Date	

3.0 SPECIFICATIONS – MATERIAL

Cast Fittings: Ductile iron conforming to ASTM A536, Grade 65-45-12. Ductile iron conforming to ASTM A395, Grade 65-45-15, is available upon special request.

Segmentally Welded Fittings: Fabricated from carbon steel pipe conforming to ASTM A53, Type E or S, Grade B or API-5L, PSL 1 or PSL 2.

Nipples: Carbon steel pipe conforming to ASTM A53, Type E or S, Grade B or API-5L, PSL 1 or PSL 2.

Flanged Adapter Nipples:

Flange: ASME/ANSI B16.5 raised face carbon steel slip-on flange.

Pipe: Carbon steel pipe conforming to ASTM A53, Type E or S, Grade B or API-5L, PSL 1 or PSL 2.

Fitting Coatings: (specify choice)

- Standard: Orange enamel.
- Optional: Hot dipped galvanized (ASTM A153) and others.
- Optional: Liquid Epoxy (AWWA C210)
- Optional: Fusion Bonded Epoxy (AWWA C213)
- Optional: Other coatings available, contact Victaulic for details.

Flanged Adapter Nipple Coating:

- None (Unfinished).
- Optional: Orange enamel.
- Optional: Hot dip galvanized and others.

Fitting Linings: (specify choice)

- Standard: Orange Enamel
- Optional: Hot Dip Galvanized (ASTM A153)
- Optional: Liquid Epoxy (AWWA C210).
- Optional: FBE (AWWA C213)
- Optional: Others available upon request contact Victaulic for details.

4.0 DIMENSIONS

Elbows and Tees

- No. W10** 90° Elbow
- No. W11** 45° Elbow
- No. W12** 22½° Elbow
- No. W13** 11¼° Elbow
(Ductile Iron¹)

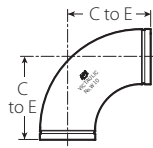

No. W10

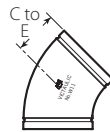

No. W11

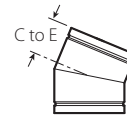

No. W12

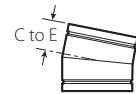

No. W13

Size		No. W10 90° Elbow		No. W11 45° Elbow		No. W12 22½° Elbow		No. W13 11¼° Elbow	
Nominal inches DN	Actual Outside Diameter inches mm	C to E inches mm	Approx. Weight Each lb kg	C to E inches mm	Approx. Weight Each lb kg	C to E inches mm	Approx. Weight Each lb kg	C to E inches mm	Approx. Weight Each lb kg
	14.843 377.0	14.84 377	157.7 71.5	6.15 156	74.7 33.9	- -	- -	- -	- -
16 DN400	16.000 406.4	16.00 406.4	184.3 83.6	6.63 168	93.8 42.5	5.00 127	52.1 23.6	4.00 102	42.0 19.1
	16.772 426.0	16.77 426	201.6 91.5	6.95 177	96.2 43.7	- -	- -	- -	- -
18 DN450	18.000 457.0	18.00 457.2	272.3 123.5	7.46 189	129.0 58.5	5.50 140	65.0 29.5	4.50 114	53.2 24.1
	18.898 480.0	18.90 480	279.0 126.6	7.83 199	132.7 60.2	- -	- -	- -	- -
20 DN500	20.000 508.0	20.00 508.0	312.0 141.5	8.28 210	165.3 75.0	6.00 152	78.6 36.0	5.00 127	65.0 29.5
24 DN600	24.000 610.0	24.00 609.6	559.8 253.9	9.94 252	264.5 120.0	7.00 178	110.3 50.0	6.00 152	94.5 42.9
26 DN650	26.000 660.4	- -	- -	- -	- -	6.75 171.5	122.0 55.3	5.00 127.0	92.0 41.7
28 DN700	28.000 711.2	- -	- -	- -	- -	7.00 177.8	136.0 61.6	5.25 133.4	104.0 47.1
30 DN750	30.000 762.0	- -	- -	- -	- -	7.25 184.2	151.0 68.4	5.25 133.4	112.0 50.8
32 DN800	32.000 812.8	- -	- -	- -	- -	7.50 190.5	167.0 75.7	5.50 139.7	124.0 56.2
36 DN900	36.000 914.4	- -	- -	- -	- -	7.75 196.9	194.0 87.9	5.50 139.7	140.0 63.5
40 DN1000	40.000 1016.0	- -	- -	- -	- -	8.75 222.3	322.0 146.1	6.25 158.8	234.0 106.1
42 DN1050	42.000 1066.8	- -	- -	- -	- -	9.00 228.6	348.0 157.8	6.25 158.8	246.0 111.5
46 DN1150	46.000 1168.4	- -	- -	- -	- -	9.25 235.0	392.0 177.8	6.50 165.1	280.0 127.1
48 DN1200	48.000 1219.2	- -	- -	- -	- -	9.50 241.3	420.0 190.5	6.80 172.7	303.0 137.4
54 DN1350	54.000 1371.6	- -	- -	- -	- -	12.00 304.8	592.0 268.5	8.75 222.3	437.0 198.2
56 DN1400	56.000 1422.4	- -	- -	- -	- -	12.25 311.2	627.0 284.4	9.00 228.6	465.0 210.1
60 DN1500	60.000 1524.0	- -	- -	- -	- -	12.75 323.9	698.0 316.6	9.25 235.0	512.0 232.2

¹ Ductile iron except those marked (sw) which are segmentally welded steel.

4.1 DIMENSIONS

Elbows and Tees

No. W100 90° Long Radius

No. W110 45° Long Radius

No. W20 Tee

(Ductile Iron¹)

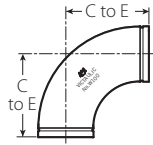

No. W100

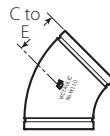

No. W110

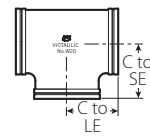

No. W20

Size		No. W100 90° Long Radius Elbow		No. W110 45° Long Radius Elbow		No. W20 Tee		
Nominal	Actual Outside Diameter	C to E	Approx. Weight Each	C to E	Approx. Weight Each	C to E Run	C to E Branch	Approx. Weight Each
inches DN	inches mm	inches mm	lb kg	inches mm	lb kg	inches mm	inches mm	lb kg
14	14.000	21.00	210.4	8.75	105.2	11.00	11.00	102.0
DN350	355.6	533	95.4	222	47.7	279	279	46.3
	14.843	-	-	-	-	11.50	11.50	176.3
	377.0	-	-	-	-	292	292	80.0
16	16.000	24.00	274.8	10.00	137.4	12.00	12.00	123.5
DN400	406.4	610	124.7	254	62.3	305	305	56.0
	16.772	-	-	-	-	13.00	13.00	226.9
	426.0	-	-	-	-	330	330	102.9
18	18.000	27.00	383.9	11.25	192.0	13.50	13.50	281.0
DN450	457.0	686	174.1	286	87.1	343	343	127.5
	18.898	-	-	-	-	14.57	14.57	312.8
	480.0	-	-	-	-	370	370	141.9
20	20.000	30.00	474.3	12.50	237.2	15.00	15.00	350.0
DN500	508.0	762	215.1	318	107.8	381	381	158.7
24	24.000	36.00	746.6	15.00	373.3	17.00	17.00	503.7
DN600	610.0	914	338.7	381	169.3	432	432	228.5
26	26.000	39.00	892.6	16.00	446.3	19.50 (sw)	19.50 (sw)	634.0
DN650	660.4	990.6	404.9	406.4	202.4	495.3	495.3	287.5
28	28.000	42.00	1019.0	17.25	491.0	20.50 (sw)	20.50 (sw)	741.0
DN700	711.2	1066.8	462.2	438.2	227.7	520.7	520.7	336.1
30	30.000	45.00	1268.0	18.50	612.0	22.00 (sw)	22.00 (sw)	855.0
DN750	762.0	1143.0	575.1	469.9	277.6	558.8	558.8	387.8
32	32.000	48.00	1517.0	19.75	733.0	23.50 (sw)	23.50 (sw)	1190.0
DN800	812.8	1219.2	688.1	501.7	332.4	596.9	596.9	539.7
36	36.000	54.00	1925.0	22.25	935.0	26.50 (sw)	26.50 (sw)	1608.0
DN900	914.4	1371.6	83.1	565.2	424.1	673.1	673.1	729.4
38	38.000	-	-	-	-	28.00 (sw)	28.00 (sw)	1496.0
DN950	965.2	-	-	-	-	711.2	711.2	678.5
40	40.000	60.00	2883.0	24.88	1397.0	29.50 (sw)	29.50 (sw)	1968.0
DN1000	1016.0	1524.0	1307.7	632.0	633.7	749.3	749.3	892.6
42	42.000	63.00	3260.0	26.00	1583.0	30.00 (sw)	28.00 (sw)	2891.0
DN1050	1066.8	1600.2	1478.7	660.4	718.1	762.0	711.2	1311.3
46	46.000	69.00 (sw)	2270.0	28.63 (sw)	1210.0	33.50 (sw)	31.50 (sw)	2620.0
DN1150	1168.4	1752.6	1029.7	727.2	548.8	850.9	800.1	1188.4
48	48.000	72.00 (sw)	2471.0	29.88 (sw)	1314.0	35.00 (sw)	33.00 (sw)	3805.0
DN1200	1219.2	1828.8	1120.8	759.0	596.1	889.0	838.2	1725.9
54	54.000	81.00 (sw)	3120.0	33.50 (sw)	1648.0	41.00 (sw)	41.00 (sw)	3656.0
DN1350	1371.6	2057.4	1415.2	850.9	747.5	1041.4	1041.4	1658.3
56	56.000	84.00 (sw)	3355.0	34.75 (sw)	1769.0	42.00 (sw)	42.00 (sw)	3961.0
DN1400	1422.4	2133.6	1521.8	882.7	802.4	1066.8	1066.8	1796.7
60	60.000	90.00 (sw)	3850.0	37.25 (sw)	2023.0	45.00 (sw)	45.00 (sw)	4325.0
DN1500	1524.0	2286.0	1746.3	946.2	917.6	1143.0	1143.0	1961.8

¹ Ductile iron except those marked (sw) which are segmentally welded steel.

4.2 DIMENSIONS

Crosses and Wyes

No. W35 Cross
No. W33 True Wye
 (Segmentally Welded Steel)

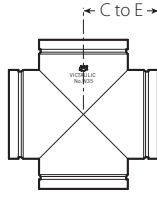

No. W35

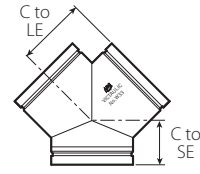

No. W33

Size		No. W35 Cross (sw)		No. W33 True Wye (sw)		
Nominal	Actual Outside Diameter	C to E	Approx. Weight Each	C to LE	C to SE	Approx. Weight Each
inches DN	inches mm	inches mm	lb kg	inches mm	inches mm	lb kg
14 DN350	14.000 355.6	11.00 279	121.0 54.9	11.00 279	7.50 191	98.0 44.4
16 DN400	16.000 406.4	12.00 305	146.4 66.4	12.00 305	8.00 203	119.3 54.1
18 DN450	18.000 457.0	13.50 343	185.4 84.1	13.50 343	8.50 216	148.3 67.3
20 DN500	20.000 508.0	15.00 381	229.1 103.9	15.00 381	9.00 229	180.4 81.8
24 DN600	24.000 610.0	17.00 432	298.7 135.5	17.00 432	10.00 254	238.3 108.1

4.3 DIMENSIONS

Reducing Tee

No. W25 Reducing Tee
(Segmentally Welded Steel)

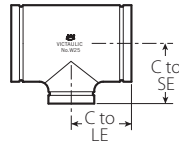

No. W25

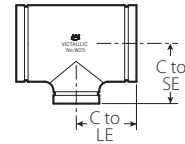

No. W25

Size			No. W25 Reducing Tee		Approx. Weight Each lb kg	
Nominal inches DN			C to LE inches mm	C to SE inches mm		
14 DN350	x	14 DN350	6 DN150	11.00 279	9.38 238	101.4 46.0
		8 DN200		11.00 279	9.75 248	102.5 46.5
		10 DN250		11.00 279	10.12 257	105.1 47.7
		12 DN300		11.00 279	10.62 270	108.1 49.0
		16 DN400		12.00 305	10.38 264	126.2 57.2
16 DN400	x	16 DN400	6 DN150	12.00 305	10.75 273	127.4 57.8
		8 DN200		12.00 305	11.12 282	129.8 58.9
		10 DN250		12.00 305	11.62 295	132.5 60.1
		12 DN300		12.00 305	12.00 305	134.6 61.1
		14 DN350		12.00 305	11.38 289	160.0 72.6
18 DN450	x	18 DN450	6 DN150	13.50 343	11.75 298	161.0 73.0
		8 DN200		13.50 343	12.12 308	163.1 74.0
		10 DN250		13.50 343	12.62 321	165.6 75.1
		12 DN300		13.50 343	13.00 330	167.6 76.0
		14 DN350		13.50 343	13.00 330	168.2 76.3
		16 DN400		13.50 343	13.00 330	168.2 76.3
		18 DN450		13.50 343	13.00 330	168.2 76.3

Size			No. W25 Reducing Tee		Approx. Weight Each lb kg	
Nominal inches DN			C to LE inches mm	C to SE inches mm		
20 DN500	x	20 DN500	6 DN150	15.00 381	12.38 314	197.0 89.5
		8 DN200		15.00 381	12.75 324	198.5 90.0
		10 DN250		15.00 381	13.12 333	200.5 90.9
		12 DN300		15.00 381	13.62 346	202.9 92.0
		14 ² DN350		15.00 381	14.00 356	204.7 92.9
		16 ² DN400		15.00 381	14.00 356	205.0 93.0
		18 DN450		15.00 381	14.50 368	208.4 94.5
		24 DN600		17.00 432	14.38 365	260.9 122.0
		8 DN200		17.00 432	14.75 375	270.0 123.0
		10 DN250		17.00 432	15.12 384	271.7 123.2
24 DN600	x	24 DN600	6 DN150	17.00 432	15.62 397	273.8 124.2
		14 DN350		17.00 432	16.00 406	275.4 125.0
		16 DN400		17.00 432	16.00 406	275.3 125.0
		18 DN450		17.00 432	16.50 419	278.1 127.1
		20 DN500		17.00 432	17.00 432	282.1 128.0
		12 DN300		17.00 432	15.62 397	273.8 124.2
		14 DN350		17.00 432	16.00 406	275.4 125.0
		16 DN400		17.00 432	16.00 406	275.3 125.0
		18 DN450		17.00 432	16.50 419	278.1 127.1
		20 DN500		17.00 432	17.00 432	282.1 128.0

² Cast fitting available. Contact Victaulic for details.

NOTE

- Outlets 12"/DN300 and smaller will be provided with original Victaulic roll or cut grooves, suitable for use with original Victaulic grooved couplings in that size range.

4.3 DIMENSIONS (Continued)

Reducing Tee

No. W25 Reducing Tee
(Segmentally Welded Steel)

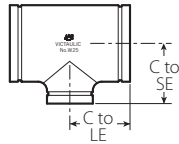

No. W25

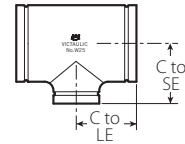

No. W25

Size			No. W25 Reducing Tee		Approx. Weight Each lb kg							
Nominal inches DN			C to LE inches mm	C to SE inches mm								
26 DN650	x	26 DN650	x	14 DN350	19.50 495.3	17.00 431.8	346.0 157.0					
					16 DN400	19.50 495.3	17.00 431.8	346.0 157.0				
					18 DN450	19.50 495.3	17.50 444.5	349.0 158.3				
					20 DN500	19.50 495.3	18.00 457.2	352.0 159.7				
					22 DN550	19.50 495.3	18.50 469.9	356.0 161.5				
					24 DN600	19.50 495.3	19.00 482.6	361.0 163.8				
					28 DN700	x	28 DN700	x	14 DN350	20.50 520.7	18.00 457.2	391.0 177.4
										16 DN400	20.50 520.7	18.00 457.2
18 DN450	20.50 520.7	18.50 469.9	393.0 178.3									
20 DN500	20.50 520.7	19.00 482.6	396.0 179.6									
22 DN550	20.50 520.7	19.50 495.3	400.0 181.4									
24 DN600	20.50 520.7	20.00 508.0	404.0 183.3									
16 DN650	20.50 520.7	20.50 520.7	410.0 186.0									
30 DN750	x	30 DN750	x	14 DN350						22.00 558.8	19.00 482.6	449.0 203.7
					16 DN400	22.00 558.8	19.00 482.6	448.0 203.2				
					18 DN450	22.00 558.8	19.50 495.3	451.0 204.6				
					20 DN500	22.00 558.8	20.00 508.0	453.0 205.5				
					22 DN550	22.00 558.8	20.50 520.7	457.0 207.3				
					24 DN600	22.00 558.8	21.00 533.4	461.0 209.1				
					26 DN650	22.00 558.8	21.50 546.1	466.0 211.4				
					28 DN700	22.00 558.8	21.50 546.1	467.0 211.8				

Size			No. W25 Reducing Tee		Approx. Weight Each lb kg								
Nominal inches DN			C to LE inches mm	C to SE inches mm									
32 DN800	x	32 DN800	x	16 DN400	23.50 596.9	20.00 508.0	510.0 231.3						
					18 DN450	23.50 596.9	20.50 520.7	512.0 232.2					
					20 DN500	23.50 596.9	21.00 533.4	515.0 233.6					
					22 DN550	23.50 596.9	21.50 546.1	518.0 235.0					
					24 DN600	23.50 596.9	22.00 558.8	522.0 236.8					
					26 DN650	23.50 596.9	22.50 571.5	527.0 239.1					
					28 DN700	23.50 596.9	22.50 571.5	527.0 239.1					
					30 DN750	23.50 596.9	23.00 584.2	533.0 241.8					
					36 DN900	x	36 DN900	x	18 DN450	26.50 673.1	22.50 571.5	648.0 293.9	
										20 DN500	26.50 673.1	23.00 584.2	650.0 294.8
										22 DN550	26.50 673.1	23.50 596.9	653.0 296.2
										24 DN600	26.50 673.1	24.00 609.6	656.0 297.6
										26 DN650	26.50 673.1	24.50 622.3	661.0 299.8
										28 DN700	26.50 673.1	24.50 622.3	661.0 299.8
30 DN750	26.50 673.1	25.00 635.0	666.0 302.1										
32 DN800	26.50 673.1	25.50 647.7	671.0 304.4										
38 DN950	x	38 DN950	x	18 DN450						28.00 711.2	23.50 596.9	722.0 327.5	
										20 DN500	28.00 711.2	24.00 609.6	724.0 328.4
					22 DN550	28.00 711.2	24.50 622.3	727.0 329.8					
					24 DN600	28.00 711.2	25.00 635.0	730.0 331.1					
					26 DN650	28.00 711.2	25.50 647.7	734.0 332.9					
					28 DN700	28.00 711.2	25.50 647.7	734.0 332.9					
					30 DN750	28.00 711.2	26.50 673.1	743.0 337.0					
					32 DN800	28.00 711.2	27.00 685.8	749.0 339.8					
					36 DN900	28.00 711.2	28.00 711.2	1003.0 455.0					

4.3 DIMENSIONS (Continued)

Reducing Tee

No. W25 Reducing Tee
(Segmentally Welded Steel)

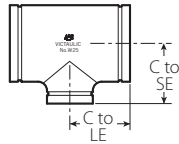

No. W25

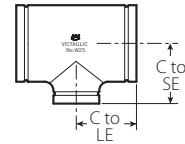

No. W25

Size			No. W25 Reducing Tee		Approx. Weight Each			
Nominal inches	DN		C to LE inches mm	C to SE inches mm				
40 DN1000	x	40 DN1000	20 DN500	29.50 749.3	25.00 635.0	802.0 363.8		
			22 DN550	29.50 749.3	25.50 647.7	804.0 364.7		
			24 DN600	29.50 749.3	26.00 660.4	808.0 366.5		
			26 DN650	29.50 749.3	26.50 673.1	811.0 367.9		
			28 DN700	29.50 749.3	26.50 673.1	811.0 367.9		
			30 DN750	29.50 749.3	27.50 698.5	820.0 371.9		
			32 DN800	29.50 749.3	28.00 711.2	826.0 374.7		
			36 DN900	29.50 749.3	29.00 736.6	1102.0 499.9		
			38 DN950	29.50 749.3	29.50 749.3	1113.0 504.9		
		42 DN1050	x	42 DN1050	20 DN500	30.00 762.0	26.00 660.4	856.0 388.3
					22 DN550	30.00 762.0	26.00 660.4	854.0 387.3
					24 DN600	30.00 762.0	26.00 660.4	853.0 386.9
					26 DN650	30.00 762.0	27.50 698.5	865.0 392.4
	28 DN700			30.00 762.0	27.50 698.5	864.0 391.9		
	30 DN750			30.00 762.0	28.00 711.2	868.0 393.7		
	32 DN800			30.00 762.0	28.00 711.2	1140.0 517.1		
	36 DN900			30.00 762.0	28.00 711.2	1139.0 516.7		
	38 DN950			30.00 762.0	28.00 711.2	1139.0 516.7		
	40 DN1000			30.00 762.0	28.00 711.2	1139.0 516.7		

Size			No. W25 Reducing Tee		Approx. Weight Each			
Nominal inches	DN		C to LE inches mm	C to SE inches mm				
46 DN1150	x	46 DN1150	22 DN550	33.50 850.9	28.50 723.9	1042.0 472.7		
			24 DN600	33.50 850.9	28.50 723.9	1046.0 474.5		
			26 DN650	33.50 850.9	29.00 736.6	1049.0 475.8		
			28 DN700	33.50 850.9	29.00 736.6	1049.0 475.8		
			30 DN750	33.50 850.9	29.00 736.6	1050.0 476.3		
			32 DN800	33.50 850.9	29.50 749.3	1055.0 478.6		
			36 DN900	33.50 850.9	30.00 762.0	1053.0 477.6		
			38 DN950	33.50 850.9	30.00 762.0	1060.0 480.8		
			40 DN1000	33.50 850.9	30.50 774.7	1060.0 480.8		
			42 DN1050	33.50 850.9	31.00 787.4	1060.0 480.8		
		48 DN1200	x	48 DN1200	24 DN600	35.00 889.0	29.00 736.6	1135.0 514.8
					26 DN650	35.00 889.0	30.00 762.0	1142.0 518.0
					28 DN700	35.00 889.0	30.00 762.0	1141.0 517.6
					30 DN750	35.00 889.0	30.00 762.0	1139.0 516.7
					32 DN800	35.00 889.0	31.00 787.4	1148.0 520.7
					36 DN900	35.00 889.0	31.00 787.4	1146.0 519.8
					38 DN950	35.00 889.0	32.00 812.8	1157.0 524.8
					40 DN1000	35.00 889.0	32.00 812.8	1157.0 524.8
					42 DN1050	35.00 889.0	32.00 812.8	1157.0 524.8
	46 DN1150			35.00 889.0	33.00 838.2	1539.0 698.1		

4.3 DIMENSIONS (Continued)

Reducing Tee

No. W25 Reducing Tee
(Segmentally Welded Steel)

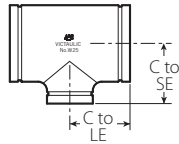

No. W25

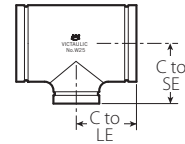

No. W25

Size			No. W25 Reducing Tee		Approx. Weight Each lb kg			
Nominal inches DN			C to LE inches mm	C to SE inches mm				
54 DN1350	x	54 DN1350	26 DN650	41.00 1041.4	41.00 1041.4	2805.0 1272.3		
		28 DN700	41.00 1041.4	41.00 1041.4	2805.0 1272.3			
		30 v750	41.00 1041.4	41.00 1041.4	2821.0 1279.6			
		32 DN800	41.00 1041.4	41.00 1041.4	2835.0 1285.9			
		36 DN900	41.00 1041.4	41.00 1041.4	2853.0 1294.1			
		38 DN950	41.00 1041.4	41.00 1041.4	2879.0 1305.9			
		40 DN1000	41.00 1041.4	41.00 1041.4	2906.0 1318.1			
		42 DN1050	41.00 1041.4	41.00 1041.4	2932.0 1329.9			
		46 DN1150	41.00 1041.4	41.00 1041.4	2985.0 1354.1			
		48 DN1200	41.00 1041.4	41.00 1041.4	3012.0 1366.2			
		56 DN1400	x	56 DN1400	28 DN700	42.00 1066.8	42.00 1066.8	3059.0 1387.5
				30 DN750	42.00 1066.8	42.00 1066.8	3075.0 1394.8	
				32 DN800	42.00 1066.8	42.00 1066.8	3087.0 1400.2	
				36 DN900	42.00 1066.8	42.00 1066.8	3111.0 1411.1	
				38 DN950	42.00 1066.8	42.00 1066.8	3137.0 1422.9	
40 v1000	42.00 1066.8			42.00 1066.8	3164.0 1434.2			
42 DN1050	42.00 1066.8			42.00 1066.8	3190.0 1447.1			
46 DN1150	42.00 1066.8			42.00 1066.8	3243.0 1471.1			
48 DN1200	42.00 1066.8			42.00 1066.8	3269.0 1482.8			
54 DN1350	42.00 1066.8			42.00 1066.8	3349.0 1519.1			

Size			No. W25 Reducing Tee		Approx. Weight Each lb kg	
Nominal inches DN			C to LE inches mm	C to SE inches mm		
60 DN1500	x	60 DN1500	30 DN750	44.00 1117.6	44.00 1117.6	3269.0 1482.8
		32 DN800	44.00 1117.6	44.00 1117.6	3308.0 1500.5	
		36 DN900	44.00 1117.6	44.00 1117.6	3345.0 1517.3	
		38 DN950	44.00 1117.6	44.00 1117.6	3386.0 1535.9	
		40 DN1000	44.00 1117.6	44.00 1117.6	3420.0 1551.3	
		42 DN1050	44.00 1117.6	44.00 1117.6	3459.0 1569.1	
		46 DN1150	44.00 1117.6	44.00 1117.6	3512.0 1593.1	
		48 DN1200	44.00 1117.6	44.00 1117.6	3538.0 1604.8	
		54 DN1350	44.00 1117.6	44.00 1117.6	3618.0 1641.1	
		56 DN1400	44.00 1117.6	44.00 1117.6	3644.0 1652.9	

4.4 DIMENSIONS

45° Lateral

No. W30

(Segmentally Welded Steel)

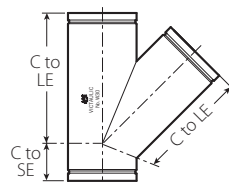

No. W30

Size		No. W30 45° Lateral		Approx. Weight Each lb kg
Nominal inches DN	Actual Outside Diameter inches mm	C to LE inches mm	C to SE inches mm	
14 DN350	14.000 355.6	26.50 673	7.50 191	219.1 99.4
16 DN400	16.000 406.4	29.00 737	8.00 203	270.5 122.7
18 DN450	18.000 457.0	32.00 813	8.50 216	332.7 150.9
20 DN500	20.000 508.0	35.00 889	9.00 229	401.3 182.0
24 DN600	24.000 610.0	40.00 1016	10.00 254	541.3 245.5

4.5 DIMENSIONS

45° Reducing Lateral

No. W30-R

(Segmentally Welded Steel)

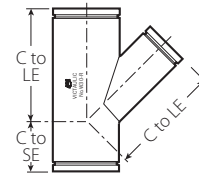

No. W30-R

Size			No. W30-R Reducing Lateral		Approx. Weight Each lb kg				
Nominal inches DN	x	Nominal inches DN	C to LE inches mm	C to SE inches mm					
14 DN350	x	14 DN350	4 DN100	26.50 673	7.50 191	175.9 79.8			
			6 DN150	26.50 673	7.50 191	185.9 84.3			
			8 DN200	26.50 673	7.50 191	195.0 88.4			
			10 DN250	26.50 673	7.50 191	204.4 92.7			
			12 DN300	26.50 673	7.50 191	213.3 96.8			
			16 DN400	x	16 DN400	6 DN150	29.00 737	8.00 203	226.4 102.7
16 DN400	x	16 DN400	8 DN200	29.00 737	8.00 203	236.0 107.1			
			10 DN250	29.00 737	8.00 203	246.0 111.6			
			12 DN300	29.00 737	8.00 203	255.1 115.7			
			14 DN350	29.00 737	8.00 203	260.9 118.4			
			18 DN450	x	18 DN450	6 DN150	32.00 813	8.50 216	274.8 124.6
			18 DN450	x	18 DN450	8 DN200	32.00 813	8.50 216	285.3 129.4
12 DN300	32.00 813	8.50 216				306.2 138.9			
14 DN350	32.00 813	8.50 216				312.4 141.7			
16 DN400	32.00 813	8.50 216				322.4 146.2			
20 DN500	x	20 DN500				12 DN300	35.00 889	9.00 229	362.1 164.3
20 DN500	x	20 DN500				14 DN350	35.00 889	9.00 229	368.7 167.2
			16 DN400	35.00 889	9.00 229	379.4 172.1			
			24 DN600	x	24 DN600	16 DN400	40.00 1016	10.00 254	494.9 224.5
24 DN600	x	24 DN600	20 DN600	40.00 1016	10.00 254	517.7 234.8			

NOTE

- Outlets 12"/DN300 and smaller will be provided with standard Victaulic roll or cut groove, suitable for use with standard Victaulic grooved couplings in that size range.

4.6 DIMENSIONS

Adapter Nipple

No. W42 AGS Grv. x Bev.

No. W43 AGS Grv. x AGS Grv.

No. W49 AGS Grv. x OGS Grv.
(Segmentally Welded Steel)

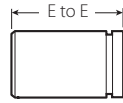

No. W42

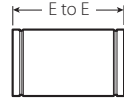

No. W43

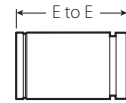

No. W49

Size		No. 42 Adapter Nipple		No. 43 Adapter Nipple		No. 49 Adapter Nipple	
Nominal inches DN	Actual Outside Dimeter inches mm	E to E inches mm	Approx. Weight (Each) lb kg	E to E inches mm	Approx. Weight (Each) lb kg	E to E inches mm	Approx. Weight (Each) lb kg
14 DN350	14.000 355.6	8.00 203	36.0 16.3	8.00 203	36.0 16.3	8.00 203	36.0 16.3
16 DN400	16.000 406.4	8.00 203	42.0 19.1	8.00 203	42.0 19.1	8.00 203	42.0 19.1
18 DN450	18.000 457.0	8.00 203	47.0 21.3	8.00 203	47.0 21.3	8.00 203	47.0 21.3
20 DN500	20.000 508.0	8.00 203	52.0 23.6	8.00 203	52.0 23.6	8.00 203	52.0 23.6
24 DN600	24.000 610.0	8.00 203	63.0 28.6	8.00 203	63.0 28.6	8.00 203	63.0 28.6
26 DN650	26.000 660.4	12.00 304.8	104.0 47.1	12.00 304.8	104.0 47.1	-	-
28 DN700	28.000 711.2	12.00 304.8	112.0 50.8	12.00 304.8	112.0 50.8	-	-
30 DN750	30.000 762.0	12.00 304.8	120.0 54.4	12.00 304.8	120.0 54.4	-	-
32 DN800	32.000 812.8	12.00 304.8	128.0 58.1	12.00 304.8	128.0 58.1	-	-
36 DN900	36.000 914.4	12.00 304.8	190.0 86.1	12.00 304.8	190.0 86.1	-	-
40 DN1000	40.000 1016.0	12.00 304.8	211.0 95.7	12.00 304.8	211.0 95.7	-	-
42 DN1050	42.000 1066.8	12.00 304.8	222.0 100.7	12.00 304.8	222.0 100.7	-	-
46 DN1150	46.000 1168.4	12.00 304.8	243.0 110.2	12.00 304.8	243.0 110.2	-	-
48 DN1200	48.000 1219.2	12.00 304.8	254.0 115.2	12.00 304.8	254.0 115.2	-	-
54 DN1350	54.000 371.6	12.00 304.8	286.0 129.7	12.00 304.8	286.0 129.7	-	-
56 DN1400	56.000 1422.4	12.00 304.8	297.0 134.7	12.00 304.8	297.0 134.7	-	-
60 DN1500	60.000 1524.0	12.00 304.8	318.0 144.2	12.00 304.8	318.0 144.2	-	-

4.7 DIMENSIONS

Flanged Adapter Nipple

No. W45R ANSI Class 150 Raised Face (Segmentally Welded Steel)

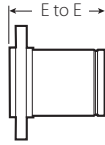

No. W45R

Size		No. W45R 45° Lateral	
Nominal inches DN	Actual Outside Diameter inches mm	E to E inches mm	Approx. Weight Each lb kg
14 DN350	14.000 355.6	8.00 203	122.0 55.3
16 DN400	16.000 406.4	8.00 203	136.0 61.7
18 DN450	18.000 457.0	8.00 203	168.0 76.2
20 DN500	20.000 508.0	8.00 203	208.0 94.3
24 DN600	24.000 610.0	8.00 203	274.0 124.3
26 DN650	26.000 660.4	12.00 304.8	254.0 115.2
28 DN700	28.000 711.2	12.00 304.8	262.0 118.8
30 DN750	30.000 762.0	12.00 304.8	270.0 122.4
32 DN800	32.000 812.8	12.00 304.8	278.0 126.1
36 DN900	36.000 914.4	12.00 304.8	340.0 154.2
40 DN1000	40.000 1016.0	12.00 304.8	361.0 163.7
42 DN1050	42.000 1066.8	12.00 304.8	372.0 168.7
46 DN1150	46.000 1168.4	12.00 304.8	393.0 178.2
48 DN1200	48.000 1219.2	12.00 304.8	404.0 183.2
54 DN1372	54.000 1371.6	16.00 406.4	436.0 197.8
56 DN1422	56.000 1422.2	16.00 406.4	447.0 202.8
60 DN1524	60.000 1524.0	16.00 406.4	468.0 212.3

4.8 DIMENSIONS

Cap

No. W60 (Segmentally Welded Steel)

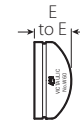

No. W60

Size		No. W60 Cap	
Nominal inches DN	Actual Outside Diameter inches mm	E to E inches mm	Approx. Weight Each lb kg
14 DN350	14.000 355.6	6.50 165.0	33.2 15.1
16 DN400	16.000 406.4	7.00 178.0	41.2 18.7
18 DN450	18.000 457.0	8.00 203.0	54.6 24.8
20 DN500	20.000 508.0	9.00 229.0	67.5 30.6
24 DN600	24.000 610.0	10.50 267.0	96.0 43.5
26 DN650	26.000 660.4	14.50 368.3	144.0 65.3
28 DN700	28.000 711.2	15.00 381.0	166.0 75.2
30 DN750	30.000 762.0	15.50 393.7	187.0 84.8
32 DN800	32.000 812.8	16.00 406.4	209.0 94.8
36 DN900	36.000 914.4	17.00 431.8	253.0 114.7
40 DN1000	40.000 1016.8	18.00 457.2	391.0 177.3
42 DN1050	42.000 1066.8	18.50 469.9	420.0 190.5
46 DN1150	46.000 1168.4	19.50 495.3	532.0 241.3
48 DN1200	48.000 1219.2	20.00 508.0	613.0 278.1
54 DN1372	54.000 1371.6	21.50 546.1	785.0 356.1
56 DN1422	56.000 1422.4	22.00 558.8	875.0 396.8
60 DN1524	60.000 1524.0	23.00 584.2	977.0 443.1

4.9 DIMENSIONS

Concentric/Eccentric Reducer

No. W50 Concentric

No. W51 Eccentric

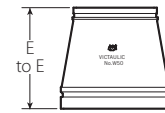

No. W50

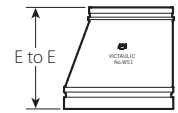

No. W51

Size	No. W50 Concentric Reducer		No. W51 Eccentric Reducer		
	Nominal inches DN	E to E inches mm	Approx. Weight (Each) lb kg	E to E inches mm	Approx. Weight (Each) lb kg
14 DN350 x	6 DN150	14.00 356	68.0 30.8	13.00 330	68.0 30.8
	8 DN200	14.00 356	70.0 31.8	13.00 330	70.0 31.8
	10 ³ DN250	14.00 356	72.0 32.7	13.00 330	72.0 32.7
	12 ³ DN300	14.00 356	74.0 33.6	13.00 330	74.0 33.6
377 mm x	10 273	13.00 330	73.6 33.4	13.00 330	81.9 37.1
	12 323.9	13.00 330	78.1 35.4	13.00 330	86.8 39.4
	16 DN400 x	14.00 356	88.0 39.9	14.00 356	88.0 39.9
10 DN250	8 DN200	14.00 356	88.0 39.9	14.00 356	88.0 39.9
	10 DN250	14.00 356	91.0 41.3	14.00 356	91.0 41.3
	12 ³ DN300	14.00 356	93.0 42.2	14.00 356	93.0 42.2
	14 ³ DN350	14.00 356	95.0 43.1	14.00 356	95.0 43.1
426 mm x	12 323.9	14.00 356	91.7 41.6	14.00 356	101.9 46.2
	377 mm	14.00 356	95.6 43.4	14.00 356	106.9 48.5
	18 DN450 x	15.00 381	112.0 50.8	15.00 381	112.0 50.8
12 DN300	10 DN250	15.00 381	112.0 50.8	15.00 381	112.0 50.8
	12 DN300	15.00 381	115.0 52.2	15.00 381	115.0 52.2
	14 ³ DN350	15.00 381	118.0 53.5	15.00 381	118.0 53.5
	16 ³ DN400	15.00 381	121.0 54.9	15.00 381	121.0 54.9
480 mm x	426 mm	15.00 381	125.1 56.8	15.00 381	139.4 63.3
	377 mm	15.00 381	119.2 54.1	15.00 381	119.2 60.9
20 DN500 x	12 DN300	20.00 508	160.0 72.6	20.00 508	160.0 72.6
	14 DN350	20.00 508	164.0 74.4	20.00 508	164.0 74.4
	16 ³ DN400	20.00 508	168.0 76.2	20.00 508	168.0 76.2
	18 ³ DN450	20.00 508	172.0 78.	20.00 508	172.0 78.
	24 DN600 x	16 DN400	20.00 508	198.0 89.8	20.00 508
18 ³ DN450	16 DN400	20.00 508	200.0 90.7	20.00 508	200.0 90.7
	20 ³ DN500	20.00 508	204.0 92.5	20.00 508	204.0 92.5

Size	No. W50 Concentric Reducer		No. W51 Eccentric Reducer			
	Nominal inches DN	E to E inches mm	Approx. Weight (Each) lb kg	E to E inches mm	Approx. Weight (Each) lb kg	
26 DN650 x	14 DN350	24.00 609.6	167.0 75.7	24.00 609.6	159.0 72.1	
	16 DN400	24.00 609.6	173.0 78.4	24.00 609.6	167.0 75.7	
	18 DN450	24.00 609.6	179.0 81.1	24.00 609.6	175.0 79.3	
	20 DN500	24.00 609.6	185.0 83.9	24.00 609.6	183.0 83.1	
	22 DN550	24.00 609.6	192.0 87.1	24.00 609.6	191.0 86.6	
	24 DN600	24.00 609.6	199.0 90.2	24.00 609.6	199.0 90.2	
	28 DN700 x	14 DN350	24.00 609.6	180.0 81.6	24.00 609.6	167.0 75.7
16 DN400		24.00 609.6	185.0 83.9	24.00 609.6	175.0 79.3	
18 DN450		24.00 609.6	190.0 86.1	24.00 609.6	183.0 83.0	
20 DN500		24.00 609.6	196.0 88.9	24.00 609.6	191.0 86.6	
22 DN550		24.00 609.6	202.0 91.6	24.00 609.6	199.0 90.2	
24 DN600		24.00 609.6	208.0 94.3	24.00 609.6	207.0 93.8	
26 DN650		24.00 609.6	216.0 97.9	24.00 609.6	215.0 97.5	
30 DN750 x		14 DN350	24.00 609.6	192.0 87.1	24.00 609.6	175.0 79.3
		16 DN400	24.00 609.6	197.0 89.3	24.00 609.6	183.0 83.1
		18 DN450	24.00 609.6	202.0 91.6	24.00 609.6	191.0 86.6
	20 DN500	24.00 609.6	207.0 93.8	24.00 609.6	199.0 90.2	
	22 DN550	24.00 609.6	213.0 96.6	24.00 609.6	207.0 93.8	
	24 DN600	24.00 609.6	218.0 98.8	24.00 609.6	215.0 97.5	
	26 DN650	24.00 609.6	225.0 102.1	24.00 609.6	223.0 101.5	
	28 DN700	24.00 609.6	232.0 105.2	24.00 609.6	232.0 105.2	

³ Ductile iron up to 24"/DN600, all other sizes are segmentally welded steel. Contact Victaulic for details.

NOTE

- Outlets 12"/DN300 and smaller will be provided with standard Victaulic roll or cut grooves, suitable for use with standard Victaulic grooved couplings in that size range.

4.9 DIMENSIONS (Continued)

Concentric/Eccentric Reducer

No. W50 Concentric

No. W51 Eccentric

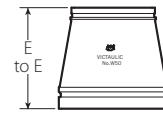

No. W50

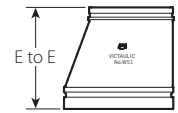

No. W51

Size		No. W50 Concentric Reducer		No. W51 Eccentric Reducer		
Nominal inches DN		E to E inches mm	Approx. Weight (Each) lb kg	E to E inches mm	Approx. Weight (Each) lb kg	
32 DN800	x 16 DN400	24.00	210.0	24.00	191.0	
		609.6	95.3	609.6	86.6	
		18 DN450	24.00	214.0	24.00	199.0
			609.6	97.1	609.6	90.3
		20 DN500	24.00	219.0	24.00	207.0
			609.6	99.3	609.6	93.9
		22 DN550	24.00	224.0	24.00	215.0
			609.6	101.6	609.6	97.5
		24 DN600	24.00	229.0	24.00	223.0
			609.6	103.9	609.6	101.2
	26 DN650	24.00	235.0	24.00	232.0	
		609.6	106.6	609.6	105.2	
	28 DN700	24.00	241.0	24.00	240.0	
		609.6	109.3	609.6	108.9	
	30 DN750	24.00	248.0	24.00	248.0	
		609.6	112.5	609.6	112.5	
36 DN900	x 18 DN450	24.00	320.0	24.00	282.0	
		609.6	145.2	609.6	127.9	
		20 DN500	24.00	325.0	24.00	292.0
			609.6	147.4	609.6	132.5
		22 DN550	24.00	330.0	24.00	303.0
			609.6	149.7	609.6	137.4
		24 DN600	24.00	336.0	24.00	314.0
			609.6	152.4	609.6	142.4
		26 DN650	24.00	342.0	24.00	324.0
			609.6	155.1	609.6	147.0
	28 DN700	24.00	348.0	24.00	335.0	
		609.6	157.9	609.6	152.0	
	30 DN750	24.00	355.0	24.00	346.0	
		609.6	161.0	609.6	157.0	
	32 DN800	24.00	363.0	24.00	356.0	
		609.6	164.7	609.6	161.5	
40 DN1000	x 20 DN500	24.00	365.0	24.00	316.0	
		609.6	165.6	609.6	143.3	
		22 DN550	24.00	369.0	24.00	326.0
			609.6	167.3	609.6	147.8
		24 DN600	24.00	373.0	24.00	337.0
			609.6	169.1	609.6	152.8
		26 DN650	24.00	377.0	24.00	346.0
			609.6	171.1	609.6	156.9
		28 DN700	24.00	382.0	24.00	357.0
			609.6	173.2	609.6	161.9
	30 DN750	24.00	387.0	24.00	367.0	
		609.6	175.5	609.6	166.4	
	32 DN800	24.00	393.0	24.00	378.0	
		609.6	178.2	609.6	171.4	
	36 DN900	24.00	407.0	24.00	399.0	
		609.6	184.6	609.6	180.9	

Size		No. W50 Concentric Reducer		No. W51 Eccentric Reducer		
Nominal inches DN		E to E inches mm	Approx. Weight (Each) lb kg	E to E inches mm	Approx. Weight (Each) lb kg	
40 DN1050	x 20 DN500	24.00	386.0	24.00	327.0	
		609.6	175.1	609.6	148.3	
		22 DN550	24.00	390.0	24.00	337.0
			609.6	176.9	609.6	152.8
		24 DN600	24.00	393.0	24.00	348.0
			609.6	178.2	609.6	157.8
		26 DN650	24.00	397.0	24.00	359.0
			609.6	180.1	609.6	162.8
		28 DN700	24.00	401.0	24.00	369.0
			609.6	181.8	609.6	167.3
		30 DN750	24.00	405.0	24.00	378.0
			609.6	183.7	609.6	171.4
		32 DN800	24.00	409.0	24.00	389.0
			609.6	185.5	609.6	176.4
	36 DN900	24.00	421.0	24.00	410.0	
		609.6	190.9	609.6	185.9	
	40 DN1000	24.00	438.0	24.00	432.0	
		609.6	198.6	609.6	195.9	
46 DN1150	x 22 DN550	28.00	479.0	28.00	419.0	
		711.2	217.2	711.2	190.1	
		24 DN600	28.00	485.0	28.00	431.0
			711.2	219.9	711.2	195.5
		26 DN650	28.00	490.0	28.00	444.0
			711.2	222.2	711.2	201.4
		28 DN700	28.00	496.0	28.00	456.0
			711.2	224.9	711.2	206.8
		30 DN750	28.00	502.0	28.00	469.0
			711.2	227.7	711.2	212.7
		32 DN800	28.00	508.0	28.00	481.0
			711.2	230.4	711.2	218.1
		36 DN900	28.00	523.0	28.00	504.0
			711.2	237.2	711.2	228.6
	38 DN950	28.00	531.0	28.00	516.0	
		711.2	240.8	711.2	234.1	
	40 DN1000	28.00	540.0	28.00	529.0	
		711.2	244.9	711.2	239.9	
	42 DN1050	28.00	550.0	28.00	542.0	
		711.2	249.4	711.2	245.8	

4.9 DIMENSIONS (Continued)

Concentric/Eccentric Reducer

No. W50 Concentric

No. W51 Eccentric

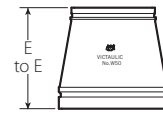

No. W50

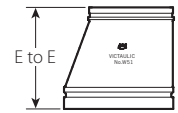

No. W51

Size		No. W50 Concentric Reducer		No. W51 Eccentric Reducer		
Nominal inches	DN	E to E inches	Approx. Weight (Each) lb	E to E inches	Approx. Weight (Each) lb	
48 DN1200 ^x	24 DN600	28.00 711.2	507.0 229.9	28.00 711.2	444.0 201.4	
	26 DN650	28.00 711.2	513.0 232.6	28.00 711.2	456.0 206.8	
	28 DN700	28.00 711.2	518.0 234.9	28.00 711.2	467.0 211.8	
	30 DN750	28.00 711.2	523.0 237.2	28.00 711.2	481.0 218.1	
	32 DN800	28.00 711.2	529.0 239.9	28.00 711.2	494.0 224.1	
	36 DN900	28.00 711.2	541.0 245.3	28.00 711.2	516.0 234.1	
	38 DN950	28.00 711.2	548.0 248.5	28.00 711.2	529.0 239.9	
	40 DN1000	28.00 711.2	557.0 252.6	28.00 711.2	542.0 245.8	
	42 DN1050	28.00 711.2	565.0 256.2	28.00 711.2	554.0 251.3	
	46 DN1150	28.00 711.2	586.0 265.8	28.00 711.2	579.0 262.6	
	54 DN1350 ^x	26 DN650	54.00 1371.6	995.0 451.3	54.00 1371.6	950.0 430.9
		28 DN700	54.00 1371.6	1015.0 460.4	54.00 1371.6	974.0 441.8
		30 DN750	54.00 1371.6	1035.0 469.4	54.00 1371.6	998.0 452.6
		32 DN800	54.00 1371.6	1054.0 478.1	54.00 1371.6	1022.0 463.5
36 DN900		54.00 1371.6	1095.0 496.6	54.00 1371.6	1070.0 485.3	
38 DN950		54.00 1371.6	1116.0 506.2	54.00 1371.6	1095.0 496.6	
40 DN1000		54.00 1371.6	1137.0 515.7	54.00 1371.6	1119.0 507.5	
42 DN1050		54.00 1371.6	1158.0 525.2	54.00 1371.6	1143.0 518.4	
46 DN1150		54.00 1371.6	1202.0 545.2	54.00 1371.6	1191.0 540.2	
48 DN1200		54.00 1371.6	1224.0 555.2	54.00 1371.6	1215.0 551.1	

Size		No. W50 Concentric Reducer		No. W51 Eccentric Reducer		
Nominal inches	DN	E to E inches	Approx. Weight (Each) lb	E to E inches	Approx. Weight (Each) lb	
56 DN1400 ^x	28 DN700	56.00 1422.4	1081.0 490.3	56.00 1422.4	1035.0 469.4	
	30 DN750	56.00 1422.4	1101.0 499.4	56.00 1422.4	1060.0 480.8	
	32 DN800	56.00 1422.4	1122.0 508.9	56.00 1422.4	1085.0 492.1	
	36 DN900	56.00 1422.4	1164.0 527.9	56.00 1422.4	1135.0 514.8	
	38 DN950	56.00 1422.4	1185.0 537.5	56.00 1422.4	1160.0 526.1	
	40 DN1000	56.00 1422.4	1207.0 547.4	56.00 1422.4	1186.0 537.9	
	42 DN1050	56.00 1422.4	1228.0 557.1	56.00 1422.4	1211.0 549.3	
	46 DN1150	56.00 1422.4	1273.0 577.8	56.00 1422.4	1261.0 571.9	
	48 DN1200	56.00 1422.4	1296.0 587.7	56.00 1422.4	1286.0 583.3	
	54 DN1350	56.00 1422.4	1368.0 620.5	56.00 1422.4	1361.0 617.3	
	60 DN1500 ^x	30 DN750	60.00 1524.0	1241.0 562.9	60.00 1524.0	1190.0 539.7
		32 DN800	60.00 1524.0	1263.0 572.8	60.00 1524.0	1217.0 552.1
		36 DN900	60.00 1524.0	1307.0 592.8	60.00 1524.0	1270.0 576.1
		38 DN950	60.00 1524.0	1330.0 603.2	60.00 1524.0	1297.0 588.3
		40 DN1000	60.00 1524.0	1353.0 613.7	60.00 1524.0	1324.0 600.5
		42 DN1050	60.00 1524.0	1376.0 624.1	60.00 1524.0	1351.0 612.8
		46 DN1150	60.00 1524.0	1423.0 645.4	60.00 1524.0	1404.0 636.8
		48 DN1200	60.00 1524.0	1447.0 656.3	60.00 1524.0	1431.0 649.1
54 DN1350		60.00 1524.0	1521.0 689.9	60.00 1524.0	1512.0 685.8	
56 DN1400		60.00 1524.0	1547.0 701.7	60.00 1524.0	1538.0 697.6	

5.0 PERFORMANCE

Flow Data

(Frictional Resistance)

The chart expresses the frictional resistance of various Victaulic fittings as equivalent feet/meters of straight pipe. Fittings not listed can be estimated from the data given, for example, a 22 ½° elbow is approximately one-half the resistance of a 45° elbow. Values of mid-sizes can be interpolated.

Size		Frictional Resistance- Equivalent					
Nominal inches DN	Actual Outside Diameter inches mm	Elbows				Tees	
		90° Elbows		45° Elbows			
		No. W10 Std. Radius Feet metres	No. W100 1 ½ D Long Radius Feet metres	No. W11 Std. Feet metres	No. W110 1 ½ D Long Radius Feet metres	Branch Feet metres	Run Feet metres
14 DN350	14.000 355.6	24.5 7.5	15.8 4.8	18.5 5.6	11.0 3.4	70.0 21.3	23.0 7.0
16 DN400	16.000 406.4	28.0 8.5	18.0 5.5	21.0 6.4	13.0 4.0	80.0 24.4	27.0 8.2
18 DN450	18.000 457.0	31.0 9.5	20.0 6.1	23.5 7.2	14.0 4.3	90.0 27.4	30.0 9.1
20 DN500	20.000 508.0	34.0 10.4	22.5 6.9	25.5 7.8	16.0 4.9	100.0 30.5	33.0 10.1
24 DN600	24.000 610.0	42.0 12.8	27.0 8.2	29.5 9.0	19.0 5.8	120.0 36.6	40.0 12.2
26 DN650	26.000 660.4	-	29.3 8.9	-	20.4 6.2	130.0 39.6	42.7 13.0
28 DN700	28.000 711.2	-	31.5 9.6	-	22.0 6.7	140.0 42.7	46.0 14.0
30 DN750	30.000 762.0	-	33.8 10.3	-	23.6 7.2	150.0 45.7	49.3 15.0
32 DN800	32.000 812.8	-	36.0 11.0	-	25.1 7.7	160.0 48.8	52.6 16.0
36 DN900	36.000 914.4	-	40.5 12.3	-	28.3 8.6	180.0 54.8	59.1 18.0
38 DN950	38.000 965.2	-	42.8 13.1	-	29.9 9.1	190.0 57.9	62.4 19.0
40 DN1000	40.000 1016.0	-	45.0 13.7	-	31.4 9.6	200.0 61.0	65.7 20.0
42 DN1050	42.000 1066.8	-	47.3 14.4	-	33.0 10.1	210.0 64.0	69.0 21.0
46 DN1150	46.000 1168.4	-	51.8 15.8	-	36.1 11.0	230.0 70.1	75.6 23.0
48 DN1200	48.000 1219.2	-	54.0 16.5	-	37.7 11.5	240.0 73.2	78.8 24.0

NOTE

- The flow data listed is based upon the pressure drop of standard wall pipe. Contact Victaulic for data on sizes not shown above.

6.0 NOTIFICATIONS

WARNING

- **Victaulic AGS products use a patented groove profile that requires the use of special AGS rolls. AGS products must not be used on pipe that has been grooved using standard grooving rolls.**

Failure to use AGS products on AGS grooved pipe could result in serious personal injury, property damage, joint leakage or joint separation.

7.0 REFERENCE MATERIALS

[02.06: Victaulic Potable Water Approvals ANSI/NSF](#)

[05.01: Victaulic Seal Selection Guide](#)

[10.01: Victaulic Products for Fire Protection Piping Systems](#)

[20.02: Victaulic AGS Rigid Coupling Style W07](#)

[20.03: Victaulic AGS Flexible Coupling Style W77](#)

[25.09: Victaulic AGS Roll Groove Data](#)

[29.01: Victaulic Terms and Conditions/Warranty](#)

[I-ENDCAP: Victaulic End Cap Installation Safety Instructions](#)

User Responsibility for Product Selection and Suitability

Each user bears final responsibility for making a determination as to the suitability of Victaulic products for a particular end-use application, in accordance with industry standards and project specifications, and the applicable building codes and related regulations as well as Victaulic performance, maintenance, safety, and warning instructions. Nothing in this or any other document, nor any verbal recommendation, advice, or opinion from any Victaulic employee, shall be deemed to alter, vary, supersede, or waive any provision of Victaulic Company's standard conditions of sale, installation guide, or this disclaimer.

Intellectual Property Rights

No statement contained herein concerning a possible or suggested use of any material, product, service, or design is intended, or should be construed, to grant any license under any patent or other intellectual property right of Victaulic or any of its subsidiaries or affiliates covering such use or design, or as a recommendation for the use of such material, product, service, or design in the infringement of any patent or other intellectual property right. The terms "Patented" or "Patent Pending" refer to design or utility patents or patent applications for articles and/or methods of use in the United States and/or other countries.

Note

This product shall be manufactured by Victaulic or to Victaulic specifications. All products to be installed in accordance with current Victaulic installation/assembly instructions. Victaulic reserves the right to change product specifications, designs and standard equipment without notice and without incurring obligations.

Installation

Reference should always be made to the Victaulic installation handbook or installation instructions of the product you are installing. Handbooks are included with each shipment of Victaulic products, providing complete installation and assembly data, and are available in PDF format on our website at www.victaulic.com.

Warranty

Refer to the Warranty section of the current Price List or contact Victaulic for details.

Trademarks

Victaulic and all other Victaulic marks are the trademarks or registered trademarks of Victaulic Company, and/or its affiliated entities, in the U.S. and/or other countries.